

GUAM EXCHANGE



Agenda

- Current State of Guam
- Guam Exchange
- Harmon Campus
- Guam Exchange

Current State of Guam



Key Issues:

- X No common interconnect point for all subsea cables
- X Local incumbents charging premiums for domestic lit capacity
- X Current Data Center options are small retrofitted CLS facilities, not meant for traditional colocation
- X No central peering point for IX traffic

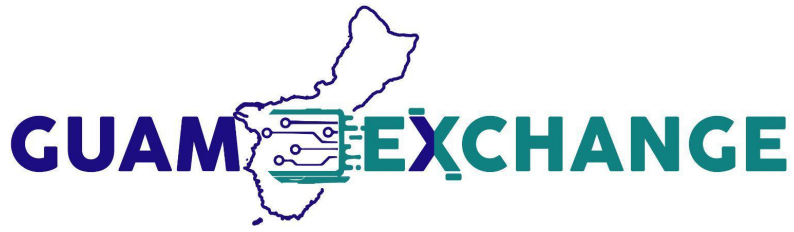

Interconnect Ecosystem

- + Central hub to access all Subsea Cables traversing Guam via x-connect at the MRR in Harmon
- + New Internet Exchange Point to tap into the 100Tbs' of new subsea capacity traversing Guam
- + Cloud Connect Gateway to prominent Cloud Service Providers

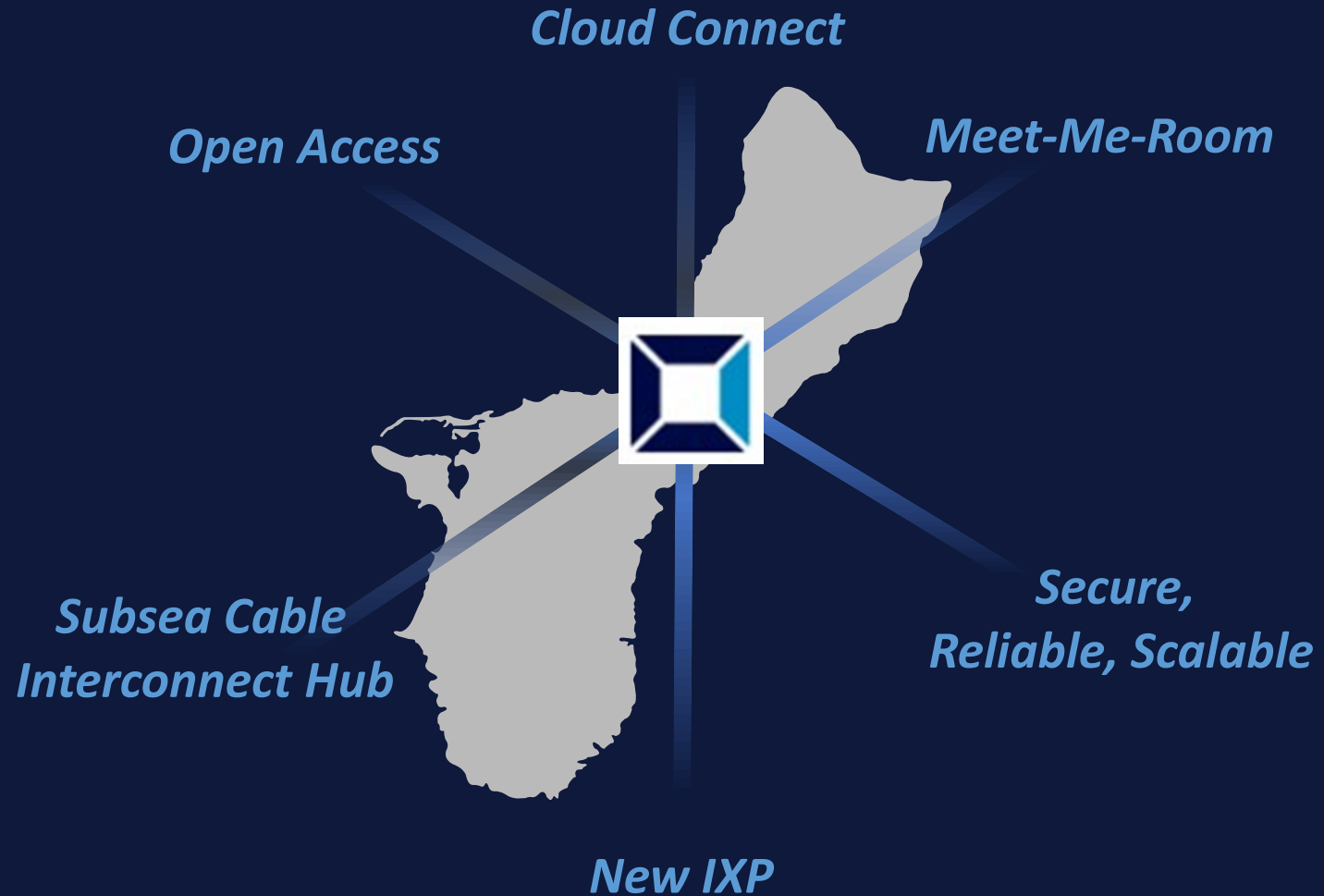

Guam Exchange: Harmon Campus

Tinian

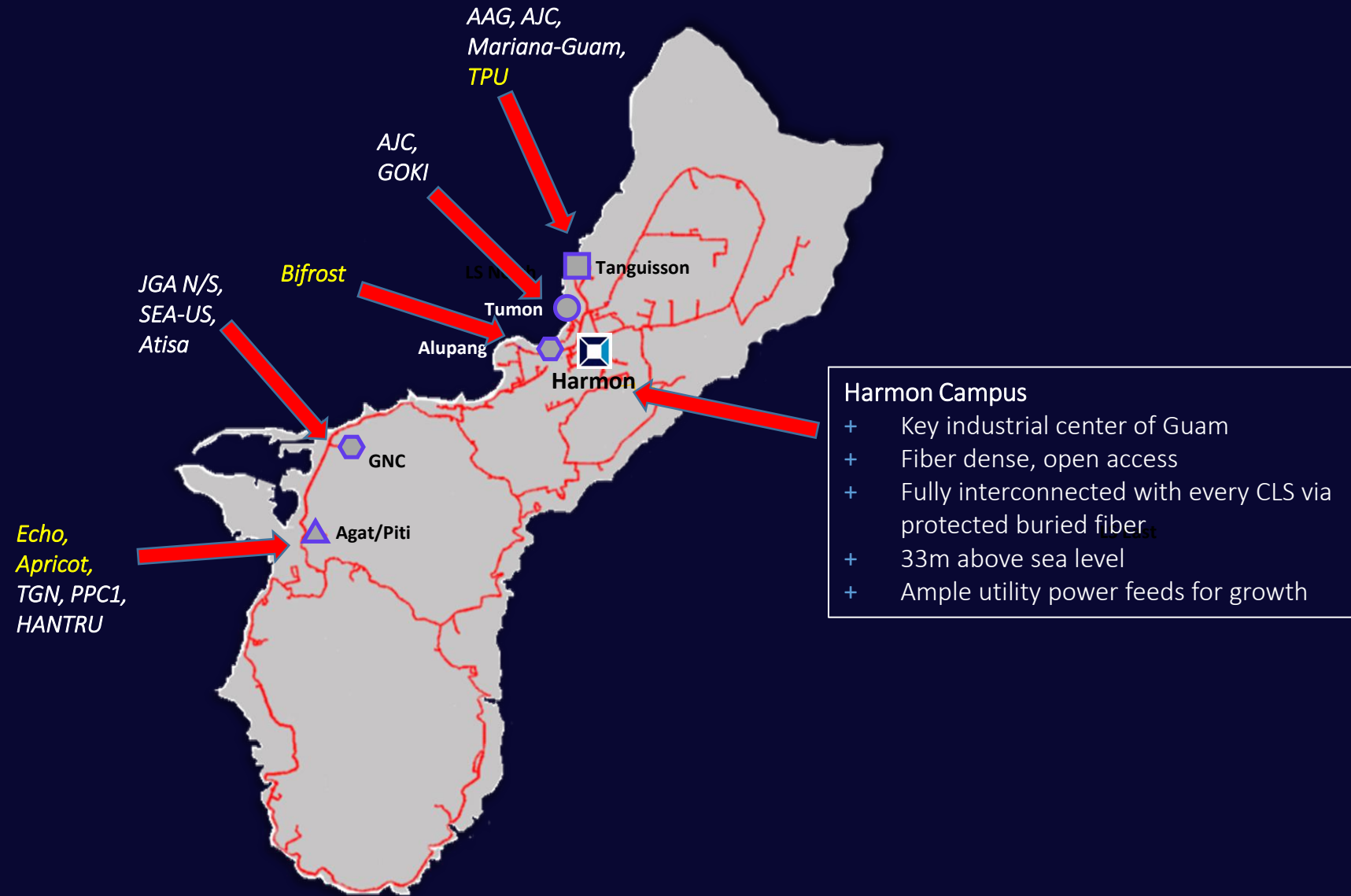

- Harmon Campus**
- + Key industrial center of Guam
 - + Fiber dense, open access
 - + Fully interconnected with every CLS via protected buried fiber
 - + 33m above sea level
 - + Ample utility power feeds for growth

Harmon 1

Data Hall Descriptions:

- + 2 DC halls with 260+ racks
- + 1.3MW IT Load
- + 7,800 sq. ft. whitespace
- + RFS June 2024

Technical Features:

- + Diesel Generator N+1
- + UPS 3N2
- + CRAC N+1 configuration
- + FM200 system
- + 7x24 BMS and DCIM systems

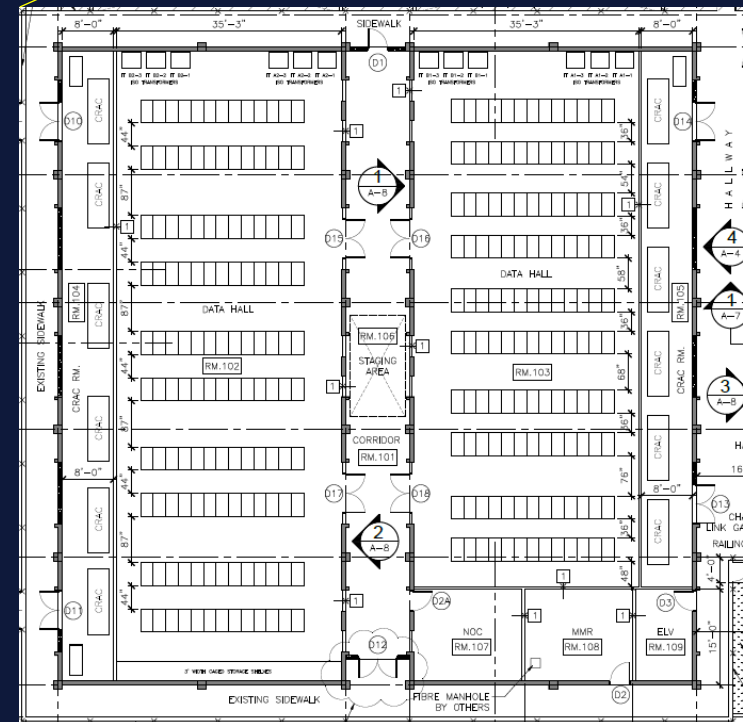
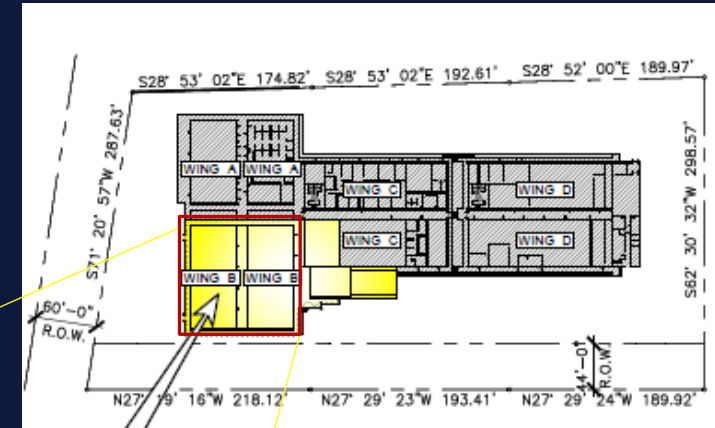

Harmon 2

- + 2MW Modular Greenfield DC
- + 2 Data Halls @400 racks
- + IT data lead-in to MMR room with diverse fiber paths
- + RFS 2025
- + Diesel Generator N+1
- + UPS N+1
- + CRAC N+1 configuration
- + FM200 system
- + 7x24 BMS and DCIM systems



Guam IX

Overview:

- + Deploying a cutting-edge Internet Exchange Point in Guam
- + 800Gbps of Ethernet traffic forwarding between IXP Customer Ports allow for scalability
- + Leveraging trusted hardware vendors
- + Highly automated and secure Internet Routing

Technical Features:

- + Arista switches, Supermicro name server, Ubiquiti Edgerouter
- + Supports 48x 10GE and 4x100GE connections



Guam Exchange: East Coast Cable Landings



Proposed East Coast Landing Stations

- + Citadel has secured land at Marbo Cave/Pago Bay for new landing points bolstering diversity in Guam
- + New Fiber builds would interconnect back to Harmon in a ring configuration
- + Marine Surveys/Permitting underway

Appendix

Tinian Proposal

- ✓ 10k sqm land parcel secured for new Powered Shell DC site (option to expand additional 5k sqm)
- ✓ Repurpose existing I&TE Landing (Bulkhead, BMH, Fronthaul ducting)
- ✓ Buried Power and Fiber concrete ducting from Power Plant to DC site
- ✓ New Cable Landing @ Lasarino Beach with trenched fronthaul concrete ducting to DC site via 8th Ave
- ✓ New 6-18MW Solar/BESS with direct connection to the DC site

